



# Assembly manual

**Power Bank / Towing Device Retrofit Kit  
97501225 (PN 01381500)**

## **Foreword**

This assembly manual may be used only in conjunction with the operating manual of the machine.

## **Safety instructions**

Please observe the general safety regulations of the corresponding machine in the relevant operating manual. Place the machine on a level surface and secure it with the parking brake. Switch the machine off and pull out the key.

We would expressly advise you that no legal claims may be asserted based on the contents of this manual. In the case of necessary repair work, please make sure that only original spare parts are used. Only original spare parts guarantee constant and reliable operational readiness of your machine. We reserve the right to make changes in the interests of further technical development.

Valid as from: April 2024

**Hako GmbH**  
**23843 Bad Oldesloe, Germany**  
**Hamburger Str. 209-239**  
**Phone +49 4531 806-0**

## Power bank / Towing device

### 1 Power bank / Towing device

#### 1.1 Parts list

- 1 1x power bank
- 2 1x adapter cable
- 3 1x M12 hex nut
- 4 1x eyebolt
- 5 1x bolt
- 6 1x right-hand towing coupling
- 7 2x M12x35 hex bolt
- 8 1x split pin

When towing, a size 19 socket spanner with extension is also required for steering.

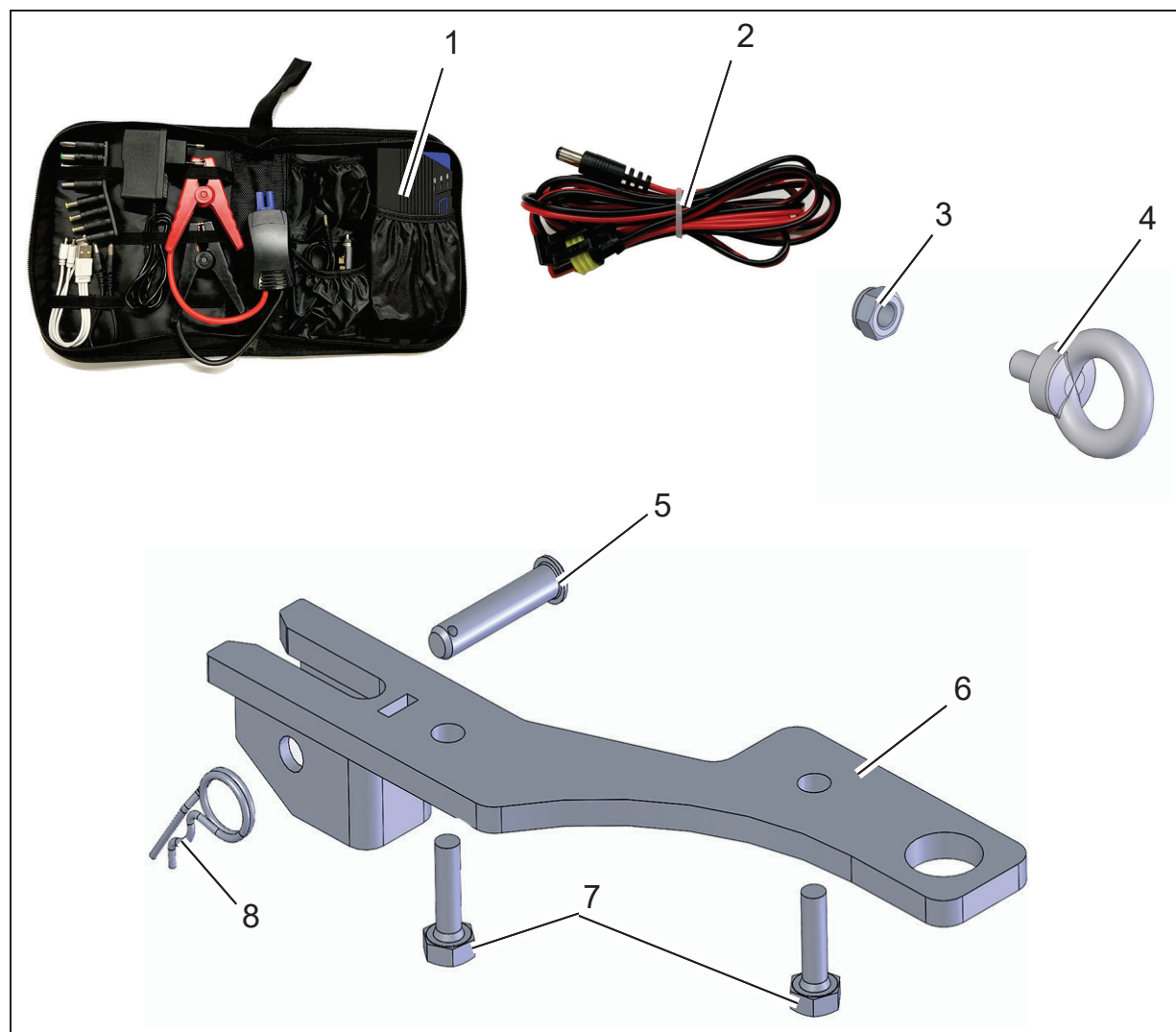

Fig. 1

## Safety instructions

### 2 Safety instructions

**Danger**

Risk of accident! The machine has no braking effect during the towing process.

Towing the machine is only permitted with a tow bar.

Towing the machine is only permitted at walking speed.

**Danger**

Risk of accident! If the machine comes to rest on an incline or decline, it must also be secured against rolling away, e.g. with wedges.

**Caution**

The machine must be switched off and the key removed before towing.

**Caution**

The brakes must be unlocked before towing.

## Towing procedure for machines from serial no.: 7190xx409991

### 3 Towing procedure for machines from serial no.: 7190xx409991

#### 3.1 Release front parking brake

1. Switch off the machine and remove the key.
2. Loosen the bolts of the steering column cover and remove the cover.
3. Disconnect the top 2-pin plug connection of the travel drive (Fig. 2/1).
4. Connect the adapter cable to the power bank and the plug connection of the travel drive (Fig. 2/2).
5. Switch on the power bank (Fig. 2/3) and set it to 19 V. To do so, press the push button until the 19 V range is selected.

For power banks with a maximum voltage of 12 volts, ensure the maximum charge level.

The parking brake is released audibly.



As long as the power bank is connected, the brake remains released.

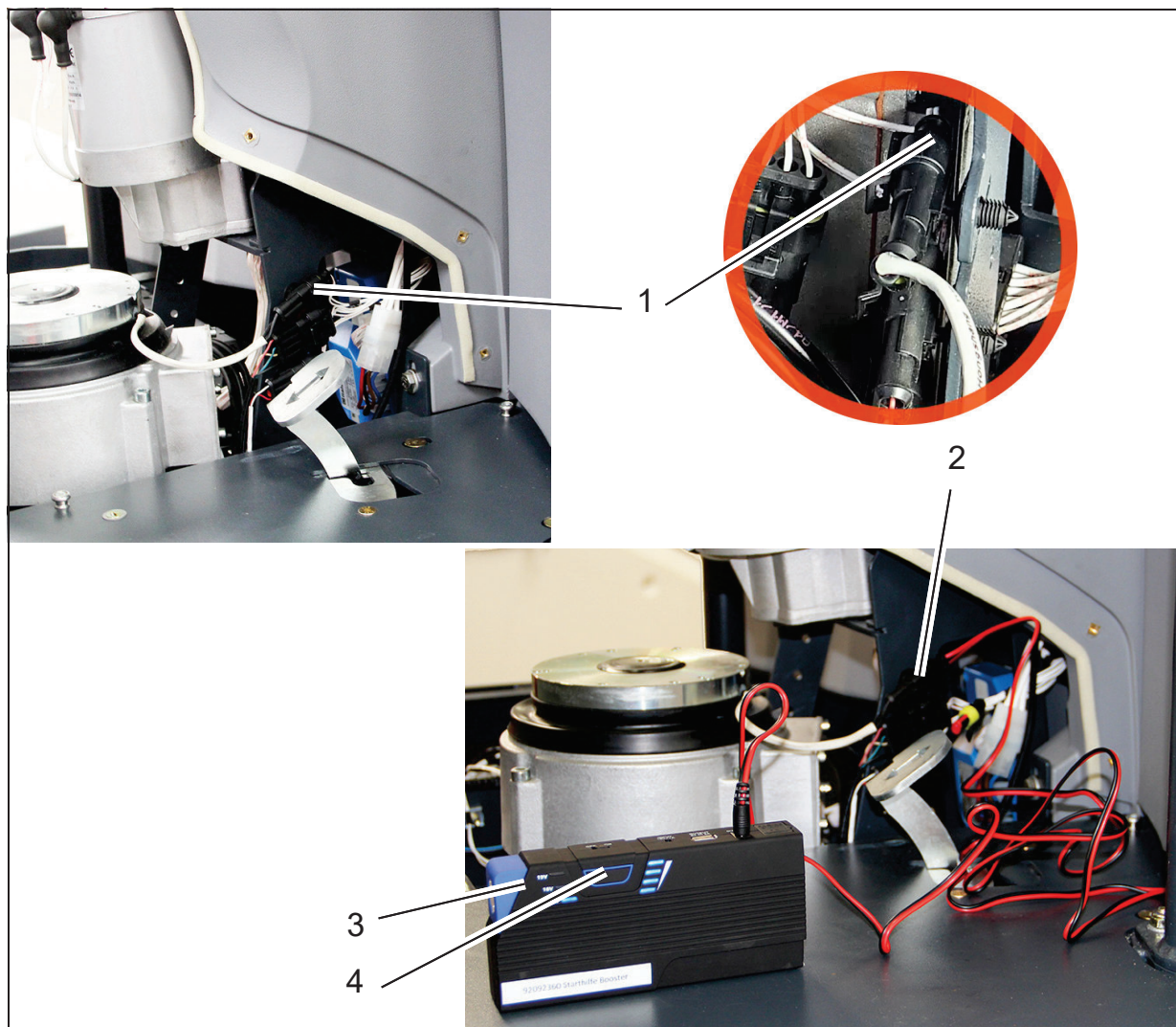

Fig. 2

## Towing procedure for machines from serial no.: 7190xx409991

### 3.2 Releasing the rear wheel brake with an X-AC drive

If the machine has an X-AC drive, the rear wheel brake must also be unlocked.

Proceed as follows:

Push the lever at the rear on the left side of the machine (Fig. 3/1) from left to right until it engages (Fig. 3/2).



#### **Danger**

After towing, the locking lever of the rear axle brake must be reset to its original position so that the machine is once again secured against rolling away.

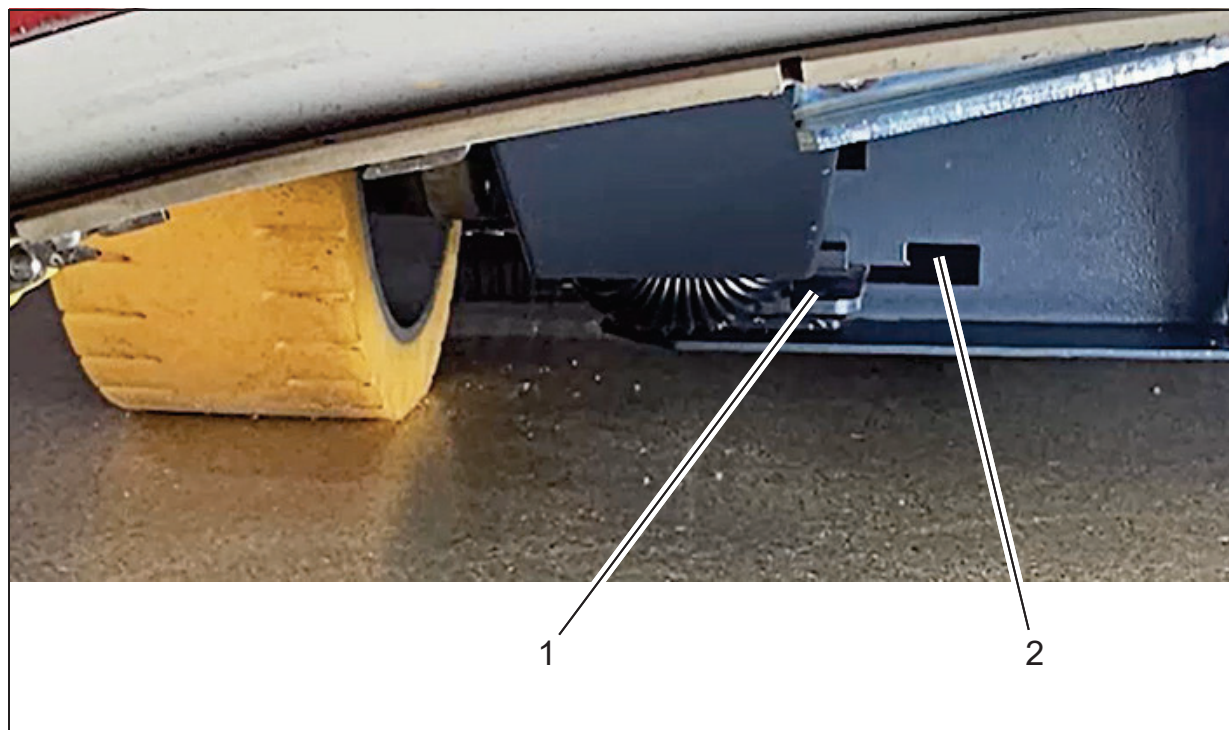

**Fig. 3**



## Towing procedure for machines from serial no.: 7190xx409991

### 3.3 Front towing coupling assembly for B400 RM/RH

To attach the tow bar, the towing coupling must be assembled at the front on the right-hand side of the machine.

1. Slide the towing coupling (Fig. 4/1) over the tab (Fig. 4/2) underneath the bar according to the illustration.
2. Attach the towing coupling with both M12x35 hexagon head bolts (Fig. 4/3) and secure it with the bolt and the split pin (Fig. 4/4).



The towing coupling must not be installed at the front of the Scrubmaster B400 R. In this case, the attachment point (Fig. 4/5) is used.

3. Attach tow bar (Fig. 4/6).



Use a standard tow bar for cars up to 3 t for towing.

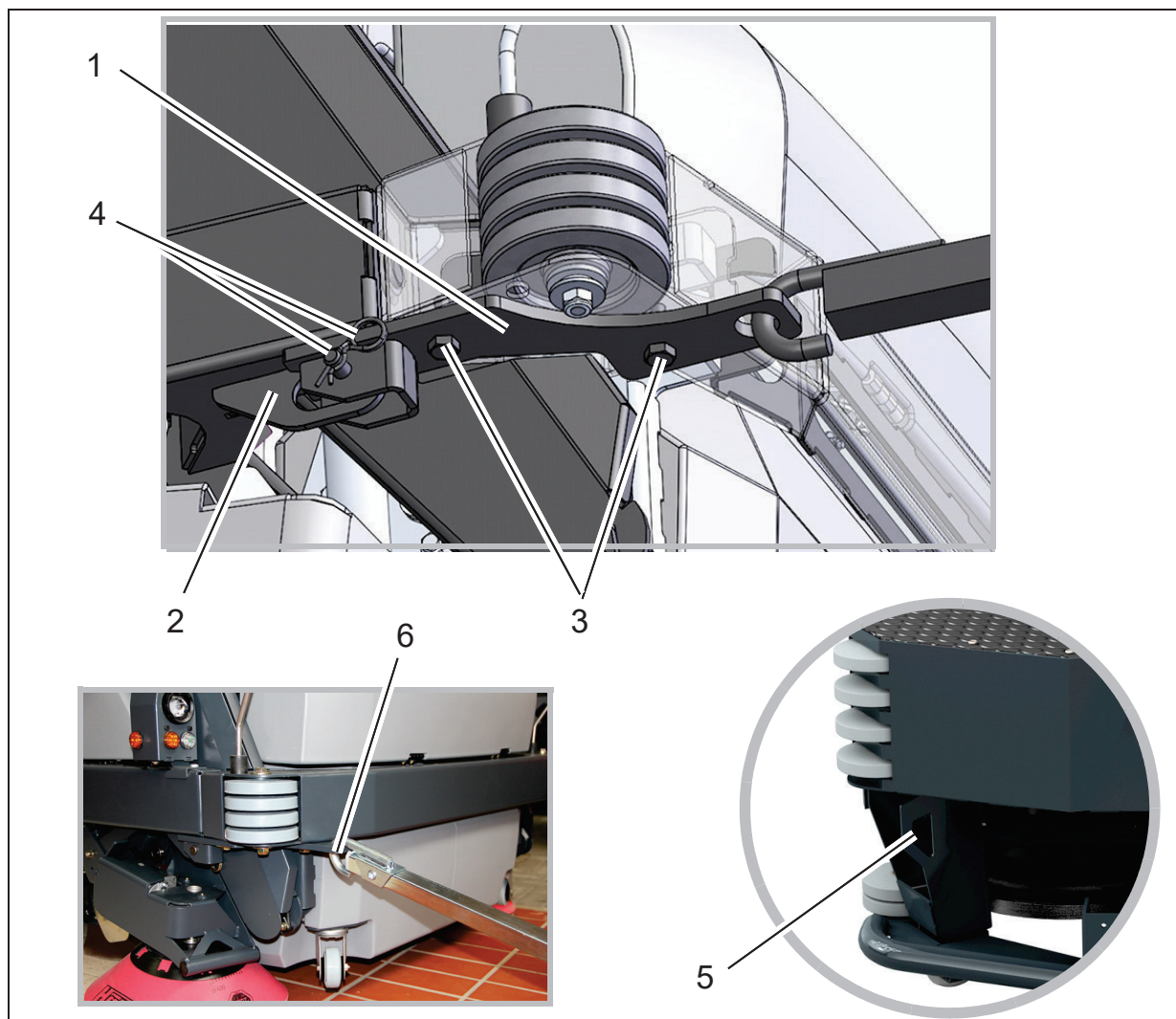

Fig. 4

## Towing procedure for machines from serial no.: 7190xx409991

### 3.4 Rear eye bolt assembly

If the tow bar is required at the rear, the eye bolt must be fitted at the rear on the right-hand side of the machine.

1. Insert the eye bolt (Fig. 5/1) through the existing hole and secure with the M 12 nut.
2. Hook the tow bar into the eye bolt (Fig. 5/2).



Use a standard tow bar for cars up to 3 t for towing.

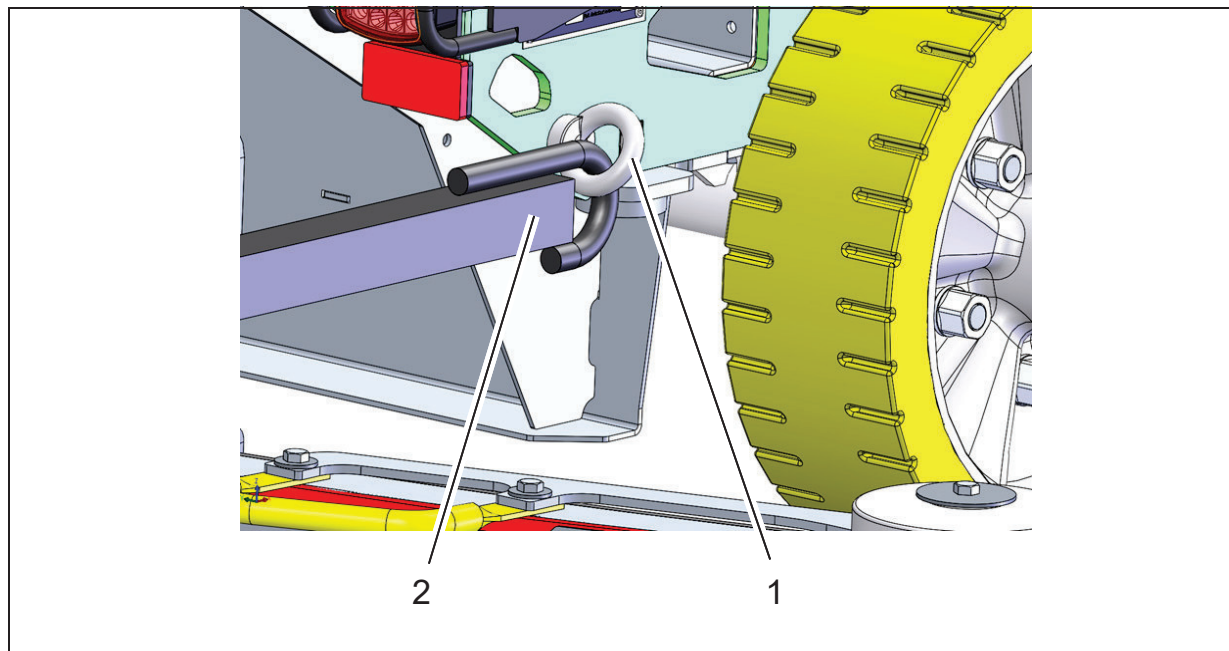

Fig. 5



## Towing procedure for machines from serial no.: 7190xx409991

### 3.5 Auxiliary steering for towing

A size 19 socket spanner with an extension is required for the auxiliary steering (not included in the scope of delivery).

1. Release the parking brake, see sections 3.1 and 3.2.
2. Remove the floor mat on the left-hand side of the machine (Fig. 6/1).
3. Insert the socket spanner through the hole in the base plate onto the drive unit (Fig. 6/2).
4. Steer the machine with the socket spanner (Fig. 6/3).

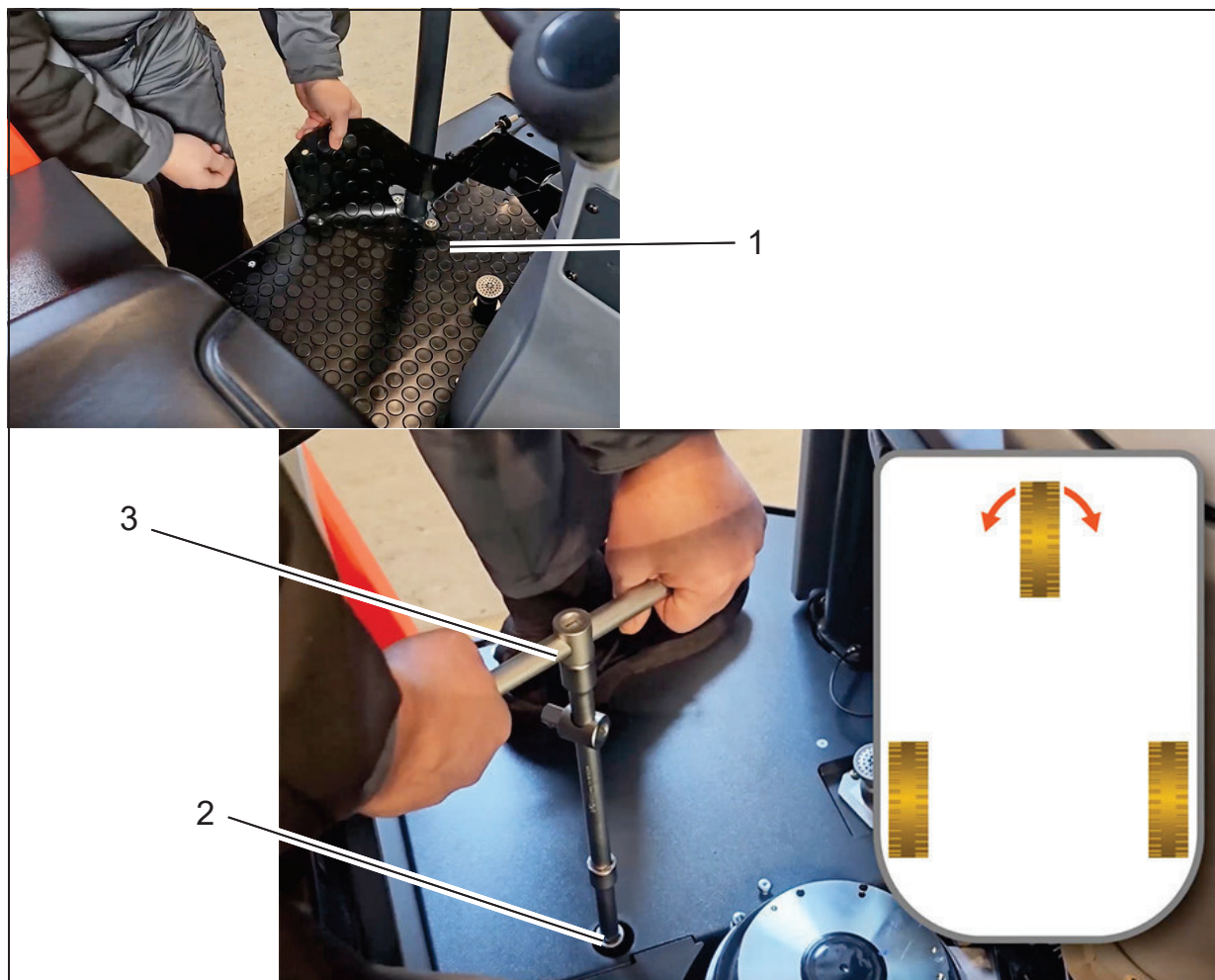

Fig. 6

## Towing procedure for machines up to serial no. 7190xx409991

### 4 Towing procedure for machines up to serial no. 7190xx409991

#### 4.1 Towing with a functioning traction battery

1. Switch off the machine and remove the key.
2. Mount the towing device at the front or rear, see sections 3.3 and 3.4.
3. Attach the tow bar.
4. If the machine has an X-AC drive, the rear wheel brake must be unlocked, see section 3.2.
5. Release the front parking brake:
  - Remove the screws from the steering column cover and fold the upper part of the cover backwards (Fig. 7/1).
  - Switch on the machine with the key switch.
  - Press the *Unlock brake* button (Fig. 7/2) and tow away.Keep the *Unlock brake* button pressed during the towing process!
6. The steering wheel is used for steering.

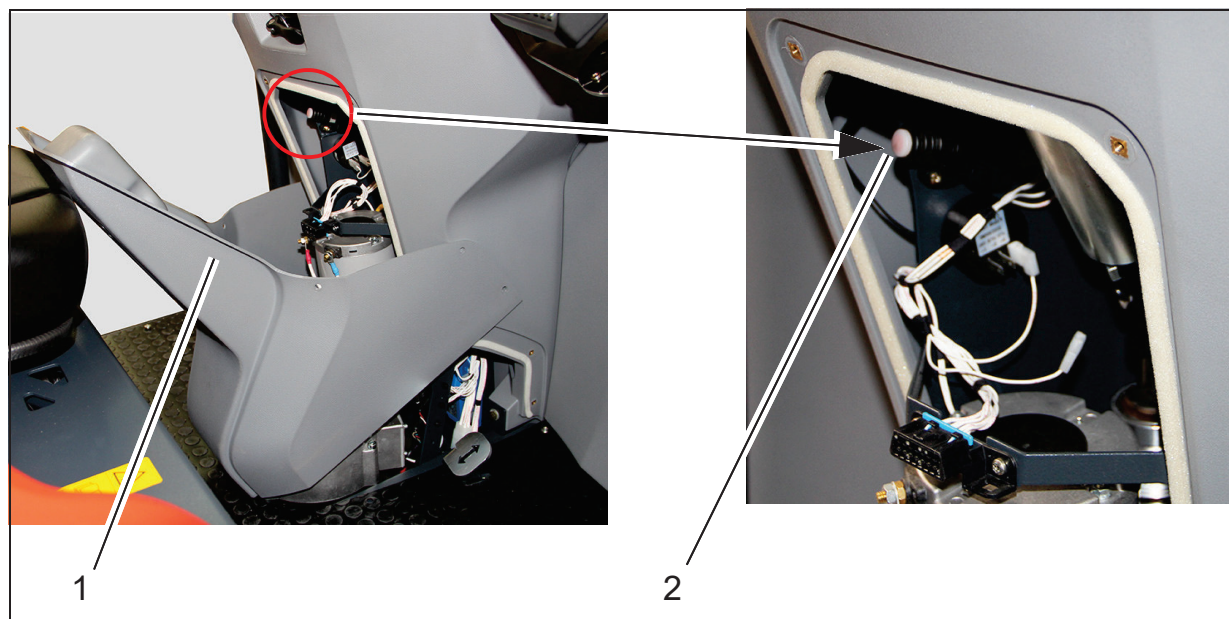

Fig. 7

## Towing procedure for machines up to serial no. 7190xx409991

### **4.2 Towing without or with a flat traction battery**

1. Switch off the machine and remove the key.
2. Mount the towing device at the front or rear, see sections 3.3 and 3.4.
3. Release the front parking brake, see sections 3.1.
4. If the machine has an X-AC drive, the rear wheel brake must be unlocked, see section 3.2.
5. Abschleppstange einhängen und abschleppen.
6. The steering wheel is used for steering.



88-60-3279 - 4480-33

Hako GmbH  
Unternehmenszentrale  
Hamburger Str. 209-239  
23843 Bad Oldesloe  
Deutschland  
Tel. +49 4531 806-0  
**info@hako.com**  
**www.hako.com**